

**How to Access View Waste Inventory:**

- Log in to the Online Services application. [Click here](#) to see sign-in instructions.
- Validate the desired generator location under the Clean Harbors logo at the top right corner. To change location, click the existing location name, which will display a list of all available locations.
- From the **Waste Inventory** tile, click and select **Waste Inventory**.

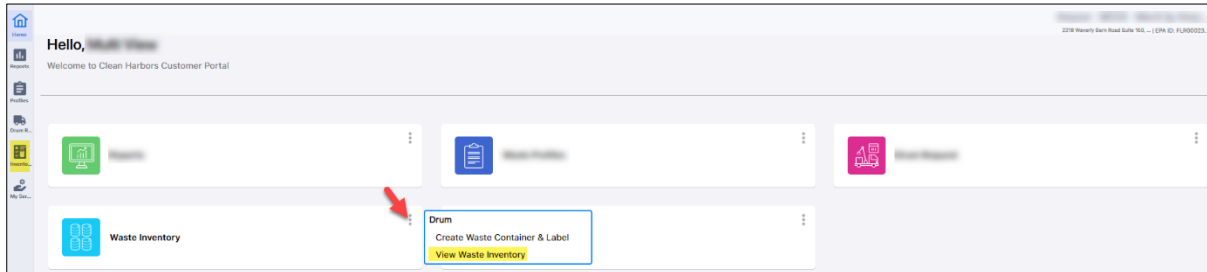
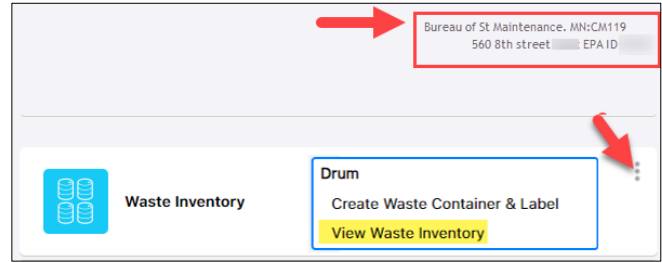

View Waste Inventory

Container age > 45 days

| Customer Container #     | Container # | Shipping Name                    | Area      | Cost Center      | Profile       | Profile Description                            | Waste Class Code | Profile Status | Drum Status | Drum Size & Type | Shipping Volume | Shi |
|--------------------------|-------------|----------------------------------|-----------|------------------|---------------|--|------------------|----------------|-------------|------------------|-----------------|-----|
| <input type="checkbox"/> | C000000009  | NON-RCRA HAZARDOUS WASTE, SOLIDS | Area CHES | Cost Center CHES | AM-TX-LEDBULB | UNIVERSAL WASTE MISC. SHAPED FLUORESCENT BULBS | CFI2             | E              | READY       | 01CF             | 1               | K   |
| <input type="checkbox"/> | C000000008  | NON-RCRA HAZARDOUS WASTE, SOLIDS | Area CHES | Cost Center CHES | AM-TX-LEDBULB | UNIVERSAL WASTE MISC. SHAPED FLUORESCENT BULBS | CFI2             | E              | READY       | 01CF             | 1               | K   |
| <input type="checkbox"/> | C000000007  | NON-RCRA HAZARDOUS WASTE, SOLIDS | Area CHES | Cost Center CHES | AM-TX-LEDBULB | UNIVERSAL WASTE MISC. SHAPED FLUORESCENT BULBS | CFI2             | E              | READY       | 01CF             | 1               | K   |
| <input type="checkbox"/> | C000000006  | NON-RCRA HAZARDOUS WASTE, SOLIDS | Area CHES | Cost Center CHES | AM-TX-LEDBULB | UNIVERSAL WASTE MISC. SHAPED FLUORESCENT BULBS | CFI2             | E              | READY       | 58DM             | 1               | G   |

Showing 1 to 4 of 4 entries Show 10 entries Previous 1 Next

|  |                     |  |                |   |                               |
|--|---------------------|--|----------------|---|-------------------------------|
|  | Create New Shipment |  | Create Drum    |   | Search                        |
|  | Bulk Edit Inline    |  | Edit Container | <input type="text" value="Container age &gt; 45 days"/> | Filter containers > 45 days   |
|  | Print Label(s)      |  | Select         |   | Filter results by each field. |
|  | Delete Container    |  | Sort           |   | Column Settings               |

**Waste Inventory - Create Waste Container & Label (Create Drum)**

1. Click **Create Drum** in **View Waste Inventory** page or Click **Create Waste Container & Label** on the Waste Inventory application tile.

Create Waste Container & Label

Location / Generator Code \*  Profile Number \*  # of Drums  Customer Container #

DOT Shipping Name (Only 1 DOT Shipping name can be used, delete all that do not apply) \*

Waste Codes

Drum Size & Type \*  Shipping Volume \*  Shipping Volume Unit of Measure \*

Area  Cost Center

Accumulation Start Date \*  Billing Comments  Drum Comments

\* Required Data

| Field Name               | Type  | Notes           |
|--------------------------|---|-----------------|
| Location/ Generator Code | Defaults to the Generator Code user is linked to. | Mandatory field |

|                                 |   |   |
|---------------------------------|---|---|
| Profile Number                  | Select from the Dropdown  | All profiles must have an A status prior to shipment. Mandatory field |
| # of Drums                      | Enter the # of drums  |   |
| Customer Container #            | Enter the Customer Container #  |   |
| DOT Shipping Name               | Select dropdown to expand the DOT section and enter the required details. | Mandatory field   |
| Ship Name or UN/NA#             | Select any one option   |   |
| Waste Codes                     | Click search and select the   |   |
| Drum Size & Type                | Select dropdown and select the size and type of the drum                  | Mandatory field   |
| Shipping Volume                 | Enter the volume of the shipping  | Mandatory field   |
| Shipping Volume Unit of Measure | Click dropdown and select the unit of measure                             | Mandatory field   |
| Area                            |   |   |
| Cost Center                     |   |   |
| Accumulation Start Date         | Select accumulation start date.   | Mandatory field   |
| Billing Comments                |   |   |
| Drum Comments                   |   |   |

- To edit the DOT shipping details, click dropdown in **DOT Shipping Name** field and enter the required details.

- Click **Create Waste Container**, to generate the Container. Once the container is generated the user can print paperwork.
- Click **Print Waste Label** to launch Clean Harbors Print Paperwork.

### Waste Inventory – Inline Edit Function (Single or Multiple)

- Click to enable inline edits for the selected waste inventory.
- User can edit **Customer Container #**, **Area**, **Cost Center**, and **Drum Size & Type**, **Shipping Volume**, **Shipping Volume UOM**, and **Accumulation Start Date**.
- Click **Save** to commit the changes or select **Cancel**.
- Page will refresh and reflect the changes.

If a user wants to edit more than one container:

- Select the checkbox of each container and click .

b. Edit the required fields and click **Save** to commit the changes.

**Waste Inventory – Copy Function**

1. Click  for the waste inventory item to be copied.
2. Enter the number of copies in **# of Copies** field and click **Copy**.

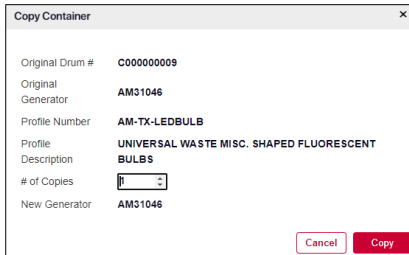

A dialog box titled "Copy Container" with a close button (X) in the top right corner. It contains the following fields:

- Original Drum #: C000000009
- Original Generator: AM31046
- Profile Number: AM-TX-LEDBULB
- Profile Description: UNIVERSAL WASTE MISC. SHAPED FLUORESCENT BULBS
- # of Copies:
- New Generator: AM31046

At the bottom right, there are two buttons: "Cancel" and "Copy".

3. Container # will display once created, select **Ok**.
4. The **View Waste Inventory** page will refresh and display the copied containers.
5. User can edit the copied Inventory Line items.

**Waste Inventory – Edit Container**

1. Click the **Container #** hyperlink.

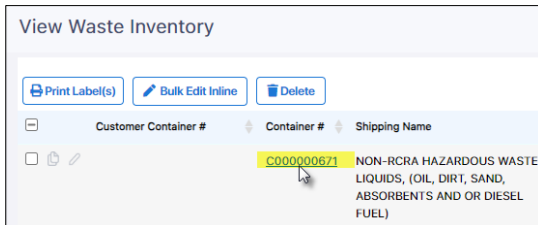

A screenshot of the "View Waste Inventory" page. At the top, there are three buttons: "Print Label(s)", "Bulk Edit Inline", and "Delete". Below these is a table with columns: "Customer Container #", "Container #", and "Shipping Name". One row is highlighted in yellow, with the "Container #" field containing the value "C000000671" and a mouse cursor hovering over it. The "Shipping Name" for this row is "NON-RCRA HAZARDOUS WASTE, LIQUIDS, (OIL, DIRT, SAND, ABSORBENTS AND OR DIESEL FUEL)".

2. On the **Edit Waste Container & Label** page make any edits applicable.
3. Click **Save Waste Container**, the **container #** will be updated to reflect changes.

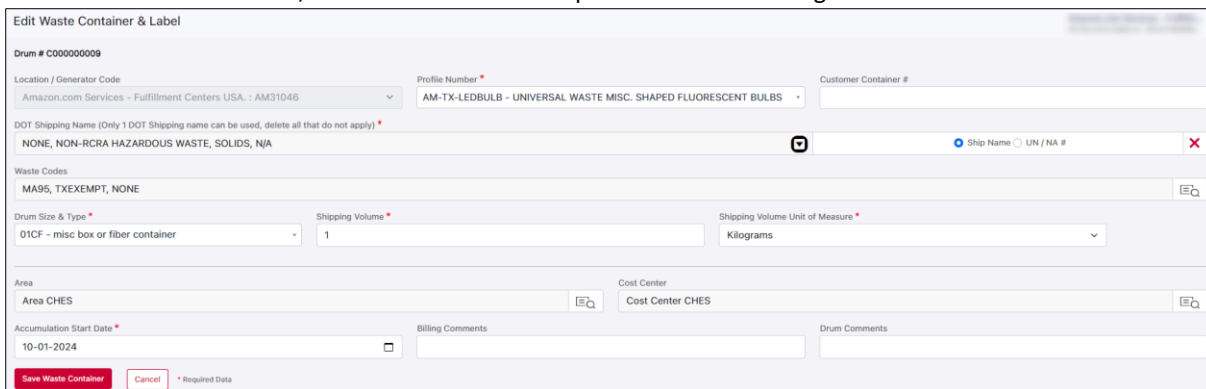

A screenshot of the "Edit Waste Container & Label" form. The form contains the following fields and sections:

- Drum #**: C000000009
- Location / Generator Code**: Amazon.com Services - Fulfillment Centers USA : AM31046
- Profile Number**: AM-TX-LEDBULB - UNIVERSAL WASTE MISC. SHAPED FLUORESCENT BULBS
- Customer Container #**: (empty field)
- DOT Shipping Name**: NONE, NON-RCRA HAZARDOUS WASTE, SOLIDS, N/A
- Waste Codes**: MA95, TXEXEMPT, NONE
- Drum Size & Type**: 01CF - misc box or fiber container
- Shipping Volume**: 1
- Shipping Volume Unit of Measure**: Kilograms
- Area**: Area CHES
- Cost Center**: Cost Center CHES
- Accumulation Start Date**: 10-01-2024
- Billing Comments**: (empty field)
- Drum Comments**: (empty field)

At the bottom left, there are three buttons: "Save Waste Container", "Cancel", and a note "\* Required Data".